



# Vestil Manufacturing Corp.

2999 North Wayne Street, P.O. Box 507, Angola, IN 46703

Telephone: (260) 665-7586 -or- Toll Free (800) 348-0868

Fax: (260) 665-1339

Web: [www.vestil.com](http://www.vestil.com) e-mail: [info@vestil.com](mailto:info@vestil.com)

## SSLP-200-2

### Short Span Lifting Plate, 20,000lb. (9,090kg) Capacity

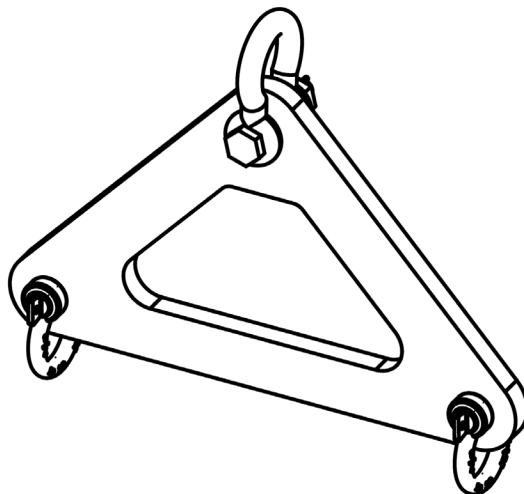

#### Receiving Instructions

After delivery, remove the packaging from the product. Inspect the product closely to determine whether it sustained damage during transport. If damage is discovered, record a complete description of it on the bill of lading. If the product is undamaged, discard the packaging.

**NOTE:** The end-user is solely responsible for confirming that product design, use, and maintenance comply with laws, regulations, codes, and mandatory standards applied where the product is used.

#### Technical Service & Replacement Parts

For answers to questions not addressed in these instructions and to order replacement parts, labels, and accessories, call our Technical Service and Parts Department at (260) 665-7586. The department can also be contacted online at [http://www.vestilmfg.com/parts\\_info.htm](http://www.vestilmfg.com/parts_info.htm).

#### Electronic copies of Instruction Manuals

Additional copies of this instruction manual may be downloaded from <https://www.vestil.com/page-manuals.php>.

Table of Contents		Page
<a href="#">Signal Words</a> .....		2
<a href="#">Safety Instructions</a> .....		2-3
<a href="#">National Standards</a> .....		3
<a href="#">Record of Satisfactory Condition</a> .....		3
<a href="#">Specifications</a> .....		3
<a href="#">Exploded View and Bill of Materials</a> .....		4
<a href="#">Using the Lifter</a> .....		4
<a href="#">Load Tests</a> .....		5
<a href="#">Inspections &amp; Maintenance</a> .....		5
<a href="#">Labeling Diagram</a> .....		6
<a href="#">Limited Warranty</a> .....		7

## SIGNAL WORDS

This manual uses SIGNAL WORDS to draw attention to uses of the product that could result in personal injuries, as well as the probable seriousness of those injuries. Other signal words call attention to uses likely to cause property damage. Signal words used in this manual appear below along with the definition of each word.



Identifies a hazardous situation which, if not avoided, WILL result in DEATH or SERIOUS INJURY. Use of this signal word is limited to the most extreme situations.



Identifies a hazardous situation which, if not avoided, COULD result in DEATH or SERIOUS INJURY.



Identifies practices likely to result in product/property damage, such as operation that might damage the product.

## SAFETY INSTRUCTIONS

Vestil strives to identify all foreseeable hazards associated with the use of its products. However, material handling is dangerous and no manual can address every conceivable risk. The most effective way to prevent injury is to apply sound judgment whenever using this device.



Material handling is dangerous and could result in serious personal injuries or death.

- **Read and understand the entire manual before using or servicing this lifter.** DO NOT use this device until you read and understand the entire instruction manual. Read the manual to refresh your understanding of proper use and maintenance procedures.
- This lifting device must only be used by designated persons and lifting device inspectors. Maintenance and test personnel should only use this device when necessary to perform their duties.
- DO NOT use this lifter if it is damaged or missing parts. Only use manufacturer-approved replacement parts.
- DO NOT modify the product in any way without first obtaining written approval from Vestil. Unapproved modifications automatically void the **LIMITED WARRANTY** and might make the product unsafe to use.
- Only attach the lifter to a properly functioning safety hook, i.e. a hook with a spring latch.
- DO NOT remove or obscure any label. Confirm the placement and legibility of all labels as shown in the **LABELING DIAGRAM** on p. 6. DO NOT use this device UNLESS all labeling is readable and undamaged.
- Inspect the lifter before each use. See **INSPECTIONS AND MAINTENANCE** on p. 5.
- Review safety messages in the manuals for your crane, trolley, hoist, rigging, and all other devices used in conjunction with this spreader beam.
- Tighten shackle pins before each use. See Load Shackle (08-145-006-001) in **EXPLODED VIEW** on p. 5.
- DO NOT use this lifter to move an item if the item does not balance when it is suspended. The bottom side of the lifter should be horizontal/level when the load is elevated.
- DO NOT lift more than 1 item at a time.
- DO NOT lift people. This lifter is a material handling device.
- Center the hoist above the load item before connecting it to a load. Centering minimizes load swing as the load lifts off of the ground. DO NOT side load the hoist/lifter.
- DO NOT sit, or ride, on the load item or the lifter.
- DO NOT exceed the rated load/capacity of your lifter (20,000 lb.; 9,090kg). See **SPECIFICATIONS** on p. 3 as well as product label #1000 shown in the **LABELING DIAGRAM** on p. 6.
- Carefully eliminate slack in the hoist line and rigging before raising the load. Lift and lower loads slowly and steadily. Avoid jolting the loads.
- Slowly raise the loaded lifter a few inches above the ground to determine whether the load is stable.
- DO NOT lift a load higher than necessary. See **USING THE LIFTER** on p. 7. Keep the suspended load as close to the ground as possible while moving it and avoid obstructions.
- Avoid contact with the load item while it is suspended. DO NOT get in front of or behind a suspended item. Avoid putting your feet and other parts of your body beneath the item. NEVER lift material over yourself or other people.
- Watch the load carefully while lifting and moving it. The load could swing or spin while elevated.

### **▲WARNING** [Continued from p. 2.]

- DO NOT leave a suspended load unattended.
- DO NOT pull, drag, or slide loads with the lifter. This product must only be used as a lifting device.

## NATIONAL STANDARDS

This product is a “Below-the-Hook Lifting Device” (BTH lifter). [ASME standard B30.20](#) (the “Standard”) applies to BTH lifters. Acquire a copy of the latest version of the Standard before putting the lifter into service. Follow all use and maintenance/care instructions provided in the Standard as well as all other provisions written for owners and users. If content in this manual conflicts with a recommendation or mandatory provision in the Standard, apply the provision from the Standard. Vestil encourages you to immediately contact [TECHNICAL SERVICE](#) if you discover any conflicts.

## RECORD OF SATISFACTORY CONDITION

Record the condition of the lifter before putting it into service. Measure the length and width of the shackles (08-145-059-A & 08-145-006-001). Include a width measurement of the mouth of each shackle, i.e. the area that receives the shackle pin. Record your measurements. Thoroughly photograph the unit from multiple angles. Include close range photos of each label and shackle. Collate all photographs and writings into a single file. Mark the file appropriately to identify it. The file provides a record of the lifter in satisfactory condition. Compare the results of all [inspections](#) (see p. 5) to this *RECORD* to determine whether the unit is in satisfactory condition. If the lifter is not in satisfactory condition, repair it before returning it to service. Purely cosmetic changes, like damaged paint/powdercoat, do not constitute changes from satisfactory condition. However, touchup paint should be applied to all affected areas as soon as cosmetic damage occurs to prevent rusting and corrosion. If left unaddressed, rusting/corrosion will alter the lifter from satisfactory condition and could make it unsafe to use.

## SPECIFICATIONS

Dimensions, net weight, and capacity information for SSLP lifters are provided below. This information is also available online to anyone who visits the Vestil website. Navigate to the webpage for model the SSLP lifter by entering the model number into the search field on the home page. Once on the product webpage, scroll the page to the “Product Specifications Table”. Click the button in the “PDF’s” column that looks like a pencil inside a blue-bordered box. A PDF file will open. This file is the specifications document. Print a copy of the document as soon as your product is delivered and keep it with your copy of this manual. If you encounter difficulties while trying to obtain a copy of the specifications document, or if you notice any differences between the document from the website and the information presented below, contact [TECHNICAL SERVICE](#). Contact information is provided on the cover page of this manual.

**SSLP-200-2**  
08-007-458

### STANDARD FEATURES

Overall length: 28<sup>1</sup>/<sub>2</sub>" (72.4cm)  
Usable length: 24" (61.0cm)  
Overall width: 6<sup>5</sup>/<sub>8</sub>" (16.8cm)  
Usable width: 3<sup>1</sup>/<sub>8</sub>" (7.9cm)  
Overall height: 24<sup>1</sup>/<sub>8</sub>" (61.3cm)  
Weight: 92 lb. (41.8kg)  
Capacity: 20,000 lb. (9,090kg)

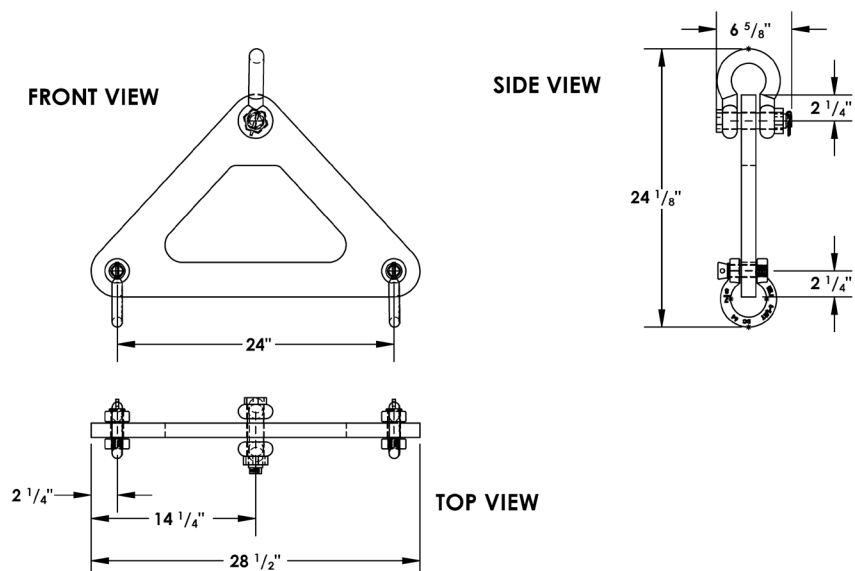

## EXPLODED VIEW & BILL OF MATERIALS: SSLP-200-2

08-006-458

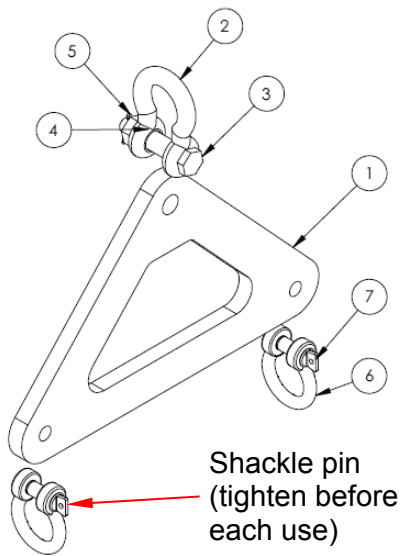

ITEM	PART NO.	DESCRIPTION	QTY.
1	08-014-237	LIFT-MASTER FRAME	1
2	08-145-059-A	SHACKLE, 20,000 LB. ("TOP SHACKLE")	1
3	08-145-059-B	SHACKLE BOLT	1
4	08-145-059-C	SHACKLE NUT	1
5	65127	COTTER PIN, Z PLATED, 3/16" x2"	1
6	08-145-006-001	SHACKLE, 10,000 LB. ("LOAD SHACKLE")	2
7	08-145-006-002	SHACKLE PIN	2

## USING THE LIFTER

**WARNING** The capacity of the hoist, crane, and rigging should equal or exceed the capacity of the lifter. DO NOT exceed the capacity of the lifter, crane, rigging, or the hoist, whichever is smallest.

Load the lifter by applying the following steps:

1. Tighten the (shackle) pins of both load shackles.
2. Center the hoist above the top shackle. Attach the hoist hook to the top shackle of the lifter.
3. Move the lifter into position above the load item. Center the top shackle and hoist above the center of gravity of the load item.
4. Attach rigging to the load item. The load must not be able to slide out of the rigging.
5. Attach the rigging to the load shackles.
6. Perform a test lift. Raise the load just a few inches above the ground. The load and lifter should balance, i.e. be horizontally level. If one end of the load item is lower than the other, return the load to the ground. Reposition rigging as necessary to balance the load item. If the load cannot be balanced, use a different device to lift the item.

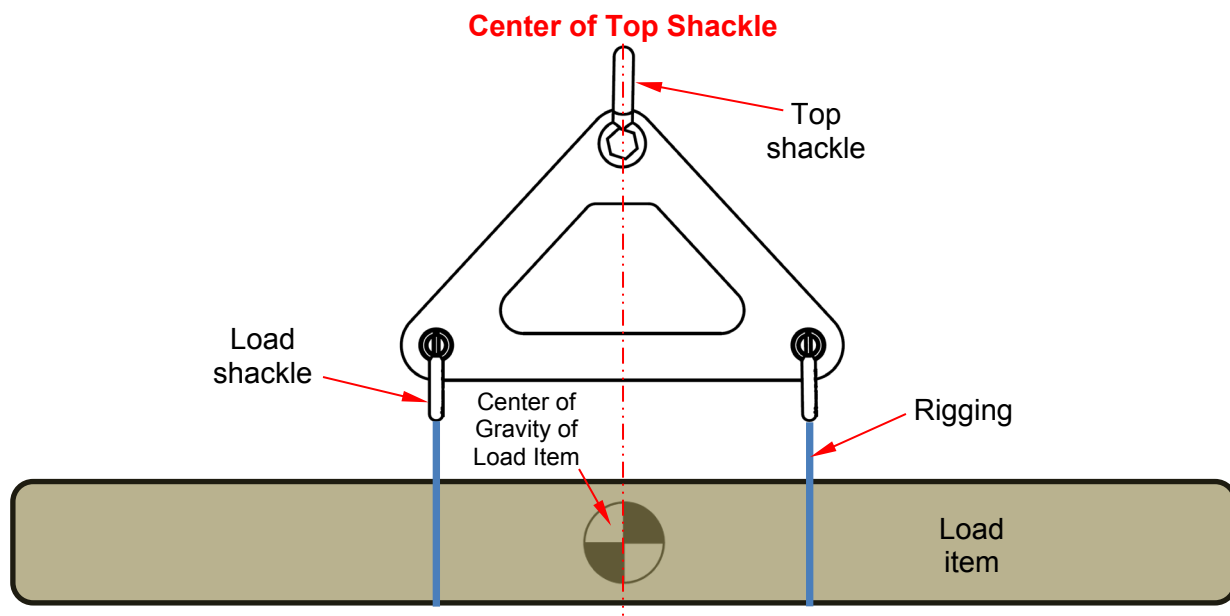

## LOAD TESTS

After creating a [RECORD OF SATISFACTORY CONDITION](#) and before putting the lifter into service, a qualified person should conduct a load test. The test load should be 125% of the rated load of the lifter, i.e. 25,000 pounds (11,364kg). Raise the test load until it is suspended a few inches above the ground. Return the lifter to the ground and unload it. Perform a [Monthly Inspection](#) as described in [INSPECTIONS AND MAINTENANCE](#) (below). The lifter must undergo load testing immediately after it is repaired, modified, or altered.

## INSPECTIONS & MAINTENANCE

Inspection procedures are included in ASME standard B30.20. As stated above in the [NATIONAL STANDARDS](#) section, Vestil recommends that you acquire a copy of the most recent revision of this standard. Apply all use and maintenance/care instructions in it. Vestil also recommends that you contact your local occupational safety and health authority to determine if any laws, regulations, codes, ordinances, etc. apply inspection requirements to below-the-hook lifters.

Inspections and repairs should only be performed by qualified persons. Compare the results of each inspection to the [RECORD OF SATISFACTORY CONDITION](#) (the "RECORD"). Do not use the lifter unless all parts are in satisfactory condition. Replace parts that are not in satisfactory condition before using the lifter again. **DON'T GUESS! If you have any questions about the condition of your lifter, contact the [TECHNICAL SERVICE](#) department.** The phone number is provided on the cover page of this manual. Never make temporary repairs of damaged or missing parts. Only use manufacturer-approved replacement parts. Deformities, cracks, and severe wear of the lifting arm or main body requires immediate replacement of the entire unit.

### **Every lift**

The operator of this lifter must inspect the lifter before each use. Look for cracks, warps, and other forms of damage. Clean dirt or other surface debris off of the lifter. Tighten the shackle pins.

### **Monthly Inspections**

At least once per month a qualified person must perform the following inspections. Written reports should be prepared for every monthly inspection including inspections following [LOAD TESTS](#).

1. Frame (08-014-237): Examine each pin/bolt hole and the surrounding metal for elongations, cracks, rusting and corrosion. Pin holes should be smooth and circular. Make sure that the metal around the pin/bolt holes is not cracked, warped, thinned, or rusted/corroded.
2. The frame should be square and rigid. There should be no cracks, warps, regions weakened by severe rusting or corrosion, etc.
3. Fasteners: Inspect the shackle bolt, nut, and cotter pin. The bolt must be straight and must have no cracks, warps, etc. Tighten the nut. Confirm that the cotter pin is in place and undamaged.
4. Load shackles and top shackle: Examine each shackle for damage including significant wear, warping, cracks, or deformation. Measure the throat opening of each shackle. Compare these measurements to the measurements in the [RECORD](#). The throat opening of each shackle should not be 15 percent or more in excess of normal throat opening or be twisted more than 10° from the plane of the unbent shackle.
5. Labeling: Labels should be readable and attached in the locations shown in the [LABELING DIAGRAM](#). If a label is unreadable, damaged, or missing, contact Vestil to order a replacement.

## LABELING DIAGRAM

Label content and location are subject to change so your product might not be labeled exactly as shown (below). Compare this labeling diagram to the **RECORD**. If actual labeling and/or label placement differs from the diagram, contact **TECHNICAL SERVICE** to determine whether the labeling of your product requires updating. During the lifetime of this lifter, replace all labels that are damaged, missing, or not easily readable (e.g. faded). To order replacement labels, contact the **TECHNICAL SERVICE** and parts department online at [http://www.vestilmfg.com/parts\\_info.htm](http://www.vestilmfg.com/parts_info.htm). Alternatively, you may request replacement parts and/or service by calling (260) 665-7586 and asking the operator to connect you to the Parts Department.

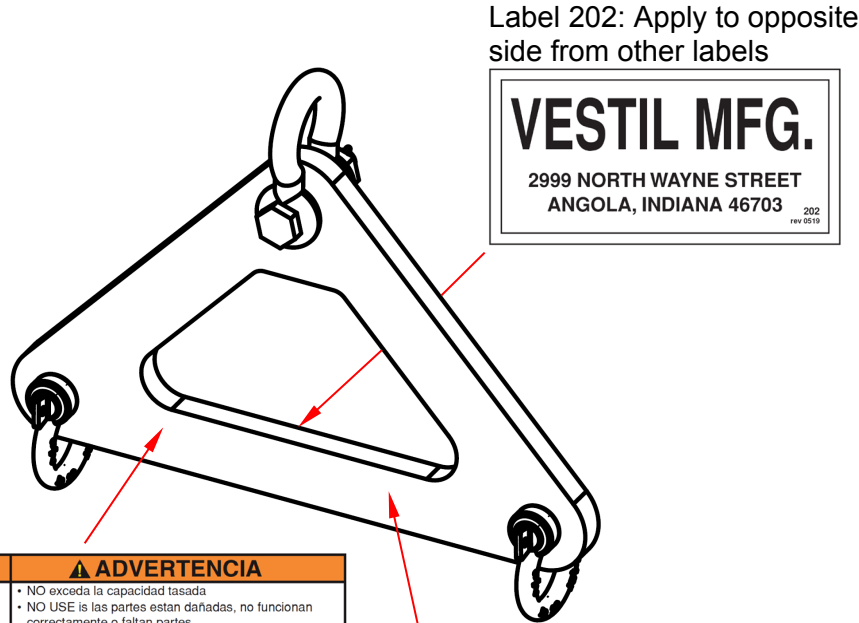

Label 202: Apply to opposite side from other labels



Label 675

⚠ WARNING	⚠ ADVERTENCIA
<ul style="list-style-type: none"> <li>• DO NOT exceed rated capacity</li> <li>• DO NOT use if damaged, malfunctioning, or missing parts</li> <li>• DO NOT lift people OR lift loads over people</li> <li>• DO NOT raise load higher than necessary</li> <li>• DO NOT leave a suspended load unattended</li> <li>• DO NOT use lifter unless you read and understand the owner's manual</li> <li>• DO NOT alter OR modify lifter</li> <li>• DO NOT remove OR obscure any label</li> <li>• STAY CLEAR of suspended loads</li> <li>• Secure load before using this device</li> </ul>	<ul style="list-style-type: none"> <li>• NO exceda la capacidad tasada</li> <li>• NO USE is las partes estan dañadas, no funcionan correctamente o faltan partes.</li> <li>• NO eleve al personal o eleve cargas sobre el personal</li> <li>• NO eleve la carga mas alto de lo necesario</li> <li>• NO deje desatendida una carga que este suspendida</li> <li>• NO use el elevador a no ser que haya leído y entendido las instrucciones del manual del propietario</li> <li>• NO altere o modifique el elevador</li> <li>• NO quite u oscurezca ninguna etiqueta</li> <li>• MANTENGASE alejado de las cargas suspendidas</li> <li>• Asegure la carga antes de usar este dispositivo</li> </ul>

Label 1000

Model No. _____	Serial No. _____
No. Modelo _____	No. Serie _____
Capacity _____ lbs.	Lifter Weight _____ lbs.
Capacidad _____ kgs.	Peso del Elevador _____ kgs.
BHT-1 Design Category: B BHT-1 Categoría de Diseño B	BHT-1 Service Category: 1 BHT-1 Categoría de Servicio: 1
<b>Read Owners Manual for product safety warnings</b>	
<b>Lea Manual de Propietarios para advertencias de seguridad de producto</b>	



## LIMITED WARRANTY

Vestil Manufacturing Corporation (“Vestil”) warrants this product to be free of defects in material and workmanship during the warranty period. Our warranty obligation is to provide a replacement for a defective, original part covered by the warranty after we receive a proper request from the Warrantee (you) for warranty service.

### Who may request service?

Only a warrantee may request service. You are a warrantee if you purchased the product from Vestil or from an authorized distributor AND Vestil has been fully paid.

### Definition of “original part”?

An original part is a part used to make the product as shipped to the Warrantee.

### What is a “proper request”?

A request for warranty service is proper if Vestil receives: 1) a photocopy of the Customer Invoice that displays the shipping date; AND 2) a written request for warranty service including your name and phone number. Send requests by one of the following methods:

<u>US Mail</u>	<u>Fax</u>	<u>Email</u>
Vestil Manufacturing Corporation 2999 North Wayne Street, PO Box 507 Angola, IN 46703	(260) 665-1339 <u>Phone</u> (260) 665-7586	<a href="mailto:info@vestil.com">info@vestil.com</a> Enter “Warranty service request” in subject field.

In the written request, list the parts believed to be defective and include the address where replacements should be delivered. After Vestil receives your request for warranty service, an authorized representative will contact you to determine whether your claim is covered by the warranty. Before providing warranty service, Vestil will require you to send the entire product, or just the defective part (or parts), to its facility in Angola, IN.

### What is covered under the warranty?

The warranty covers defects in the following original, dynamic parts: motors, hydraulic pumps, motor controllers, and cylinders. It also covers defects in original parts that wear under normal usage conditions (“wearing parts”), such as bearings, hoses, wheels, seals, brushes, and batteries.

### How long is the warranty period?

The warranty period for original dynamic components is 90 days. For wearing parts, the warranty period is 90 days. Both warranty periods begin on the date Vestil ships the product to the Warrantee. If the product was purchased from an authorized distributor, the periods begin when the distributor ships the product. Vestil may, at its sole discretion, extend a warranty period for products shipped from authorized distributors by up to 30 days to account for shipping time.

### If a defective part is covered by the warranty, what will Vestil do to correct the problem?

Vestil will provide an appropriate replacement for any *covered* part. An authorized representative of Vestil will contact you to discuss your claim.

### What is not covered by the warranty?

The Warrantee (you) is responsible for paying labor costs and freight costs to return the product to Vestil for warranty service.

### Events that automatically void this Limited Warranty.

- Misuse;
- Negligent assembly, installation, operation or repair;
- Installation/use in corrosive environments;
- Inadequate or improper maintenance;
- Damage sustained during shipping;
- Collisions or other accidents that damage the product;
- Unauthorized modifications: Do not modify the product IN ANY WAY without first receiving written authorization from Vestil.

### Do any other warranties apply to the product?

Vestil Manufacturing Corp. makes no other express warranties. All implied warranties are disclaimed to the extent allowed by law. Any implied warranty not disclaimed is limited in scope to the terms of this Limited Warranty. Vestil makes no warranty or representation that this product complies with any state or local design, performance, or safety code or standard. Noncompliance with any such code or standard is not a defect in material or workmanship.

